



Hiddenbed ™

BED AND DESK SYSTEM



All Products are Proudly Made in the U.S.A.

Bristol Hiddenbed

shown with two rolling file carts. Features a pillow storage headboard, decorative moldings and handle cutouts.

QUEEN SIZE

Shown in
Chocolate finish



Hiddenbed 

We craft the Hiddenbed from solid hardwoods and premium furniture grade hardwood plywood to create a beautiful piece of furniture that is built to last.

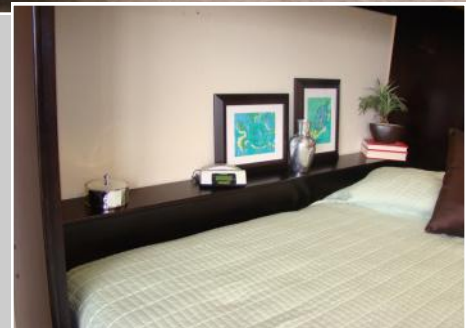

Pillow Storage Headboard

Deluxe
Bristol
Queen
Hiddenbed
with hutch
shown with
the 3 drawer
wardrobe in
the Natural
Finish.

BW50
BPWQ



Deluxe Bristol
with hutch shown
with the file pier
Cabinet; 2 lateral file
drawers, pencil drawer
and a wardrobe
door concealing a clothes
hangar bar. Beneath
the desktop is the
rolling file cart.

Sunset Finish
QUEEN SIZE

BW50 BPXQ BFC

Hiddenbed 



Queen Avalon with hutch shown with the File pier cabinet; 2 lateral file drawers, pencil drawer and open adj. shelves above.

Sunset Finish

AW50 APLQ



Hiddenbed ™





Avalon Hiddenbed

shown in full size with a 3 drawer pier cabinet and a wardrobe pier cabinet.

Cinnamon Finish



Bed with Desk combination that allows for space saving at it's best. Leave your stuff on the massive desk pluged-in, and switch between bed and desk functions with one push.



© WESTCOTT DESIGNS INC.



Avalon with Hutch shown in Full Size



Sunset Finish



Hiddenbed ™



Queen Avalon shown In Chocolate.

AB50D

© WESTCOTT DESIGNS INC



Pillow Storage Headboard

The large desk folds down into a fully made bed without disturbing anything on the desktop! The desktop remains perfectly level as the bed is lowered into position - nothing on the surface is disturbed. This large work surface may be used as a computer area, sewing center or crafts table, handling loads up to 80 lbs.



Hiddenbed ™



Avalon shown in Full Size





CB46

© WESTCOTT DESIGNS INC

Hiddenbed ™

PRODUCT OF WESTCOTT DESIGNS

*A patented revolutionary
bed and desk system*

*The secret is in its balancing
mechanism*

*Everything stays on the desktop
when you lower the bed down.*

SHOWN IN SUNSET OAK



WALLBEDS COMPANY



© WESTCOTT DESIGNS INC

BRISTOL QUEEN DELUXE HIDDENBED

HIDDENBED is a patented revolutionary bed and desk system. The secret is in its balancing mechanism. Everything stays on the desktop when you lower the bed down. Deluxe Queen Hiddenbed features a pillow storage headboard, decorative trim moldings and the cut out hand hold. We craft the HIDDENBED in the U.S. from solid birch hardwood and premium furniture grade plywood. Features a pillow storage headboard. Bed cabinet is 22" deep. Accepts standard bedding (not included) up to 10" thick.

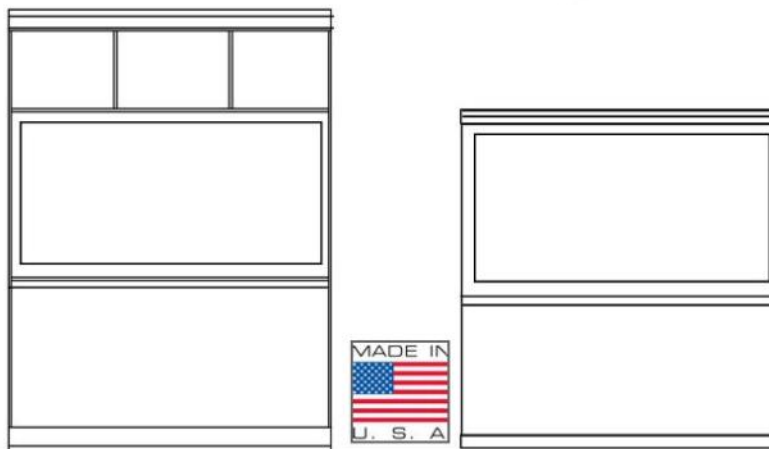

Birch finishes: NATURAL (N), MAPLE (M), SUNSET (S), CINNAMON (E), CHERRY (C), CHOCOLATE (D), WHITE (W), UNFINISHED(U)

SKU	DESCRIPTION	DESK DIMENSIONS	BED DIMENSIONS	WT/CUFT
BW50	QUEEN HIDDENBED WITH HUTCH	88.50 w x 50.5d x 90h	88.50w x 70d x 90h	525/55
BB50	QUEEN HIDDENBED	88.50w x 50.5d x 75h	88.50w x 70d x 75h	465/49

PIER CABINETS

Decorative handle Choices; Classic Brass, Nickel Cup, Stainless Bar, Black Cup, Black Mission, Atherly Bronze or Bronze Twist.

ROLLING FILE CART

Bottom lateral file drawer, medium drawer and pencil drawer. Fits under hiddenbed desk. Must be removed to lower the bed.

BFC 16w x 17d x 29h

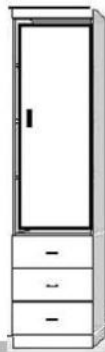
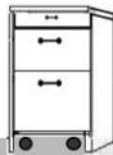

Mini Wardrobe
Three drawers, door with clothes valet and shelf inside.

BPWQ 24w x 17d x 90h



File Wardrobe
Two lateral file drawers, Pencil drawer, upper door with clothes valet

BPXQ 24w x 17d x 90h



File Pier Two file drawers, pencil drawer, with open adjustable shelves above.

BPLQ 24w x 17d x 90h

BLQS 16w x 17d x 90h



Pull Out Tray
Two drawers, Pull out tray, with open adjustable shelves above.

BPNQ 24w x 17d x 90h

BNQS 16w x 17d x 90h

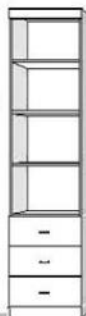

Three Drawer
Three drawers, with open adjustable shelves above.

BPGQ 32w x 17d x 90h

BPTQ 24w x 17d x 90h

BTQS 16w x 17d x 90h



Door Pier
One door with open adjustable shelves above.

BPCQ 24w x 17d x 90h

BDQS 16w x 17d x 90h

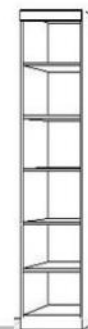

Bookcase
Center fixed shelf with adjustable shelves.

BPPQ 24w x 17d x 90h

BBQS 16w x 17d x 90h

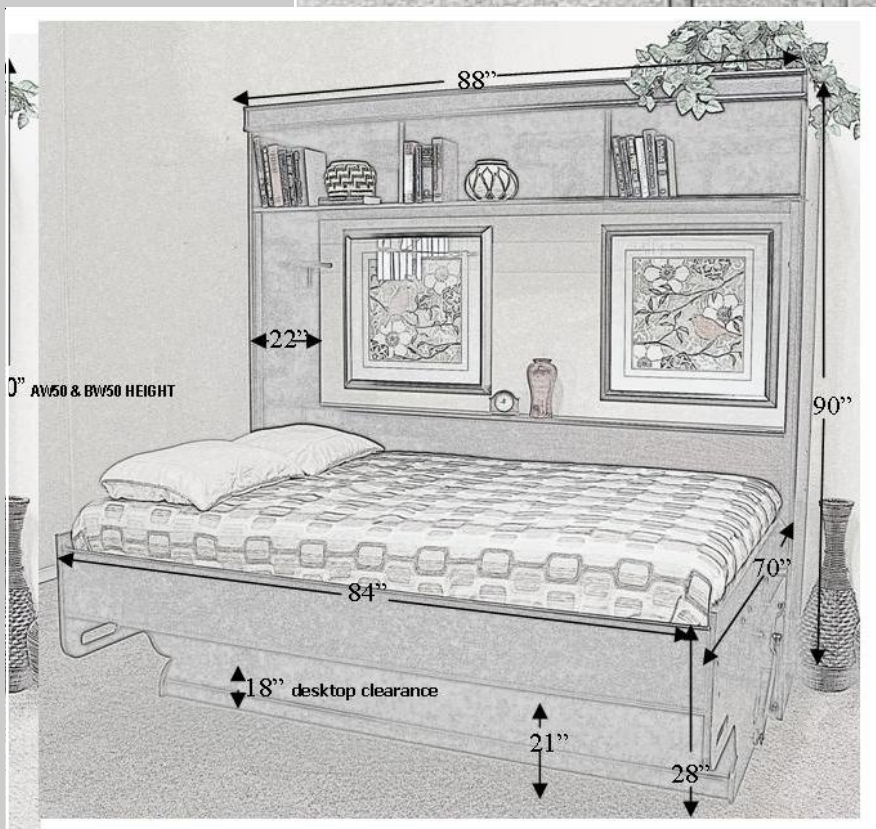
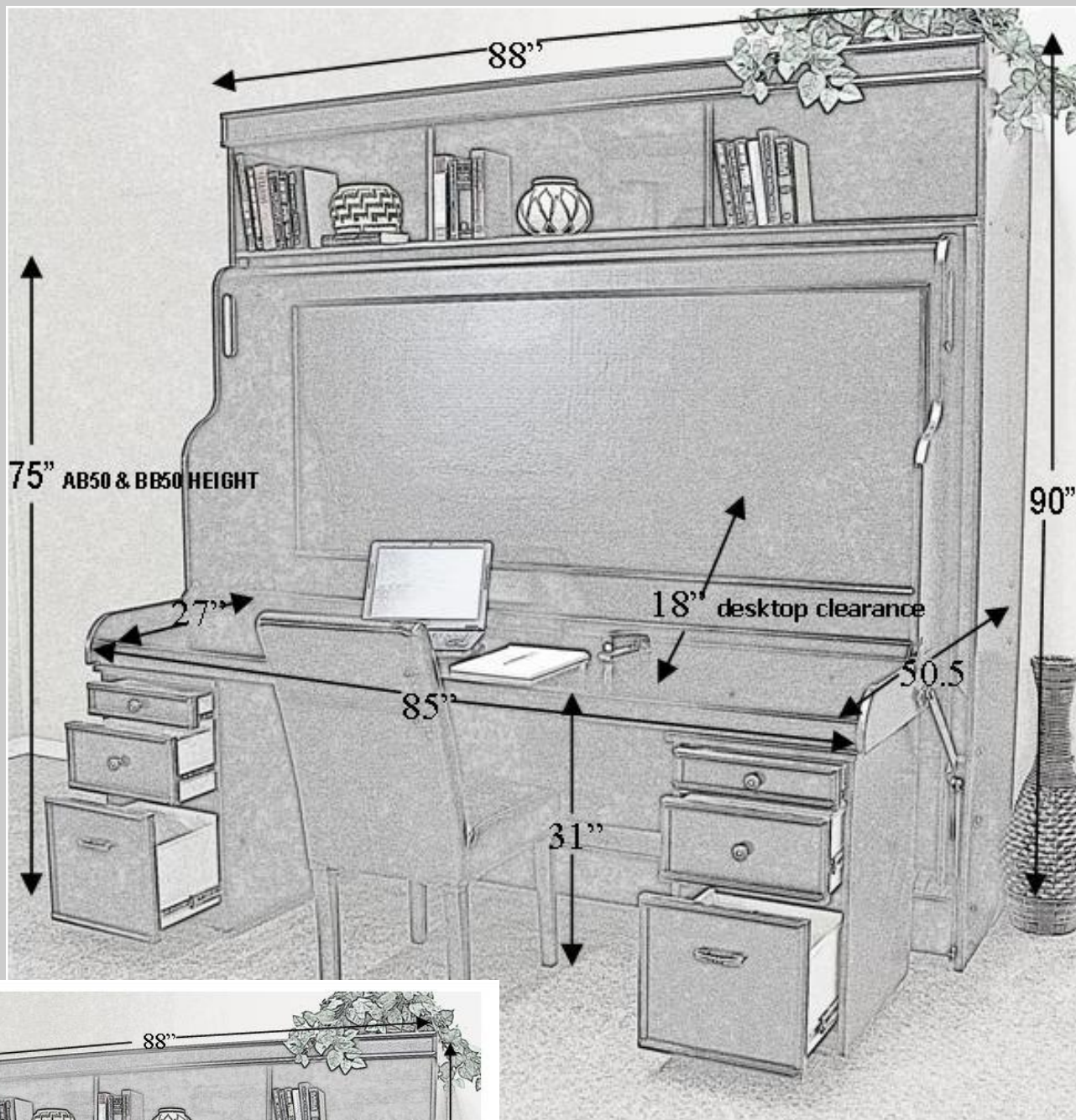

**QUEEN HIDDENBED
WITH HUTCH
DIMMENSIONS**

MODELS: AW50, BW50

*The Hiddenbed accepts standard bedding up to 10" thick (not incl.)
The supporting platform that is part of your Hiddenbed is designed as a beam structure affording the same flexibility and support of a standard mattress foundation (box spring).*

AVALON HIDDENBED

HIDDENBED is a patented revolutionary bed and desk system. The secret is in its balancing mechanism. Everything stays on the desktop (items up to 18" in height) when you lower the bed down. We craft the HIDDENBED in the U.S. from solid birch hardwood and premium furniture grade plywood. Attaches to the wall at the top with three screws into studs. Accepts standard bedding (not included) up to 10" thick .

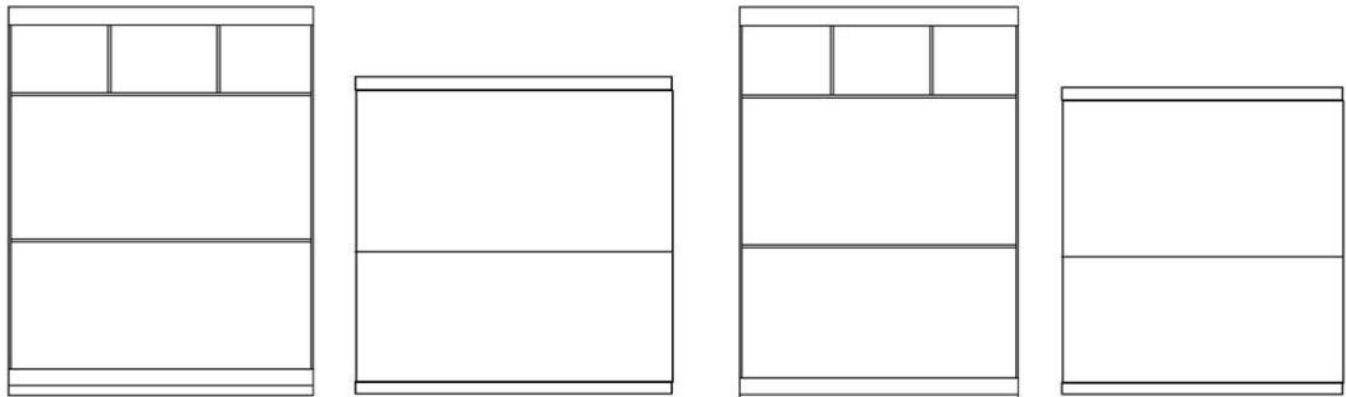

SKU	DESCRIPTION	DESK DIMENSIONS	BED DIMENSIONS	WT/CUFT
AW50	QUEEN BIRCH HIDDENBED WITH HUTCH	88.50w x 50.5d x 90h	88.50w x 70d x 90h	525/55
AB50	QUEEN BIRCH HIDDENBED	88.50w x 50.5d x 75h	88.50w x 70d x 75h	465/49
AW46	FULL BIRCH HIDDENBED WITH HUTCH	84w x 44 x 90h	84w x 64d x 90h	385/55
AB46	FULL BIRCH HIDDENBED	84w x 44d x 75h	84w x 64d x 75h	370/49
CB46	FULL OAK HIDDENBED	84w x 44 x 75h	84w x 64d x 75h	370/49

AVALON BIRCH PIER CABINETS (not available for CB46 oak model)



Decorative handle Choices, #1 Classic Brass, #2 Nickel Cup, #3 Stainless Bar, #4 Black Cup, #5 Black Mission, #6 Atherly Bronze, #7 twisted Bronze, #8 Atherly Nickel.

ROLLING FILE CART

Bottom lateral file drawer, medium drawer and pencil drawer. Fits under hiddenbed desk. Must be removed to lower the bed.

AFC 16.5" w x 21.5" d x 28" h

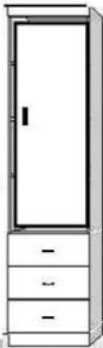
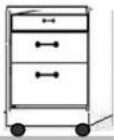

Mini Wardrobe

Three drawers, door with clothes valet and shelf inside. (left or right handle)

SKU	WT/CU	DIMENSIONS
APWQ	160/26	24w x 17d x 90h



File Wardrobe

Two lateral file drawers, Pencil drawer, upper door with clothes valet and shelf inside. (left or right handle)

SKU	WT/CU	DIMENSIONS
APXQ	160/26	24w x 17d x 90h



File Pier Two file drawers, pencil drawer, with open adjustable shelves above.

SKU	WT/CU	DIMENSIONS
APLQ	150/26	24w x 17d x 90h
ALQS	125/18	16w x 17d x 90h



Pull Out Tray

Two drawers, Pull out tray, with open adjustable shelves above.

SKU	WT/CU	DIMENSIONS
APNQ	150/26	24w x 17d x 90h
ANQS	125/18	16w x 17d x 90h

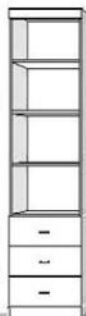

Three Drawer

Three drawers, with open adjustable shelves above.

SKU	WT/CU	DIMENSIONS
APGQ	160/34	32w x 17d x 90h
APTQ	150/26	24w x 17d x 90h
ATQS	125/18	16w x 17d x 90h



Door Pier

One door with open adjustable shelves above.

SKU	WT/CU	DIMENSIONS
APCQ	120/26	24w x 17d x 90h
ADQS	100/18	16w x 17d x 90h



Bookcase

Center fixed shelf with adjustable shelves.

SKU	WT/CU	DIMENSIONS
APBQ	110/26	24w x 17d x 90h
ABQS	100/18	16w x 17d x 90h

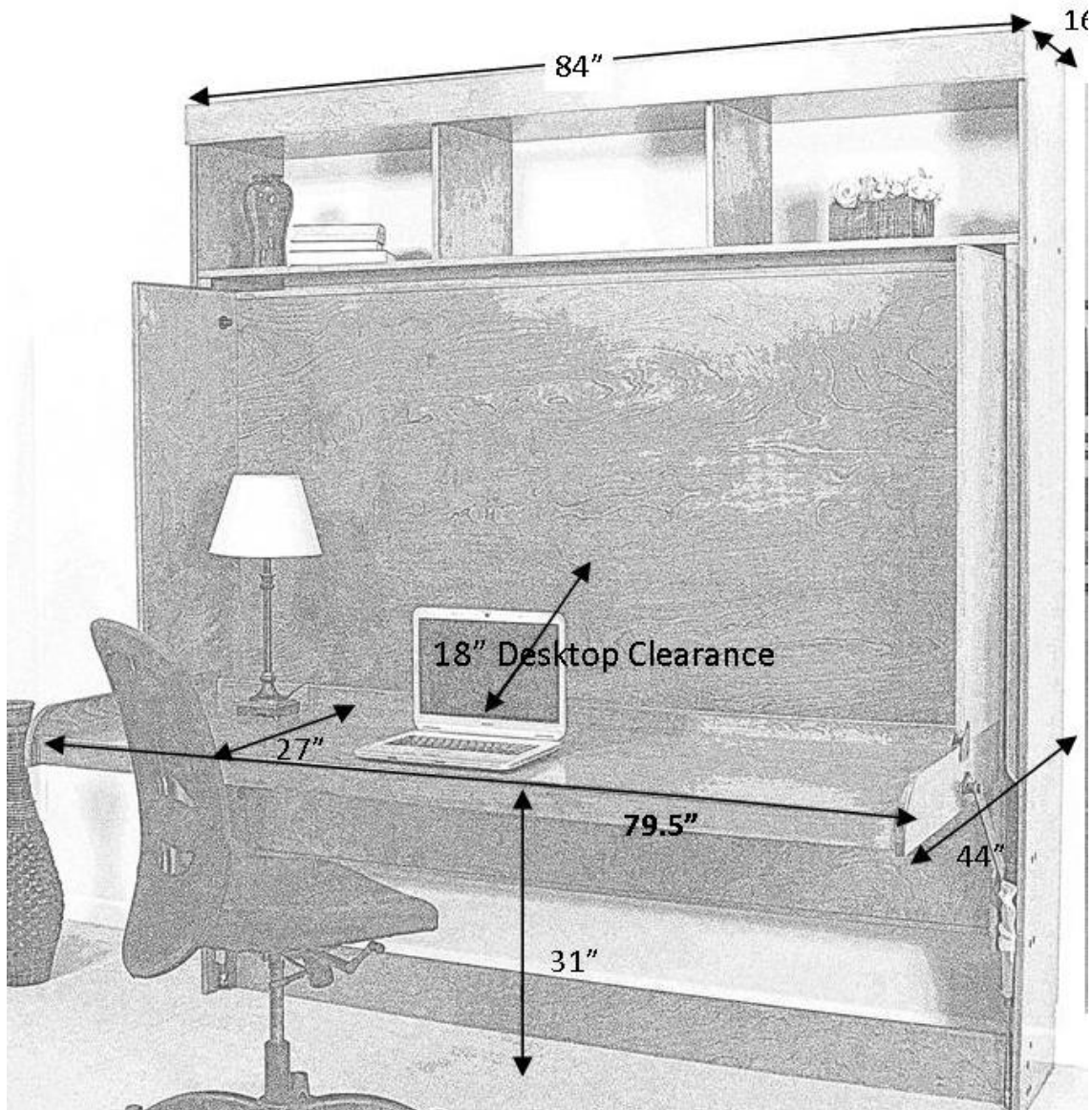

FULL AVALON WITH HUTCH DIMMENSIONS

MODEL: AW46

The Hiddenbed accepts standard bedding up to 10" thick (not incl.) The supporting platform that is part of your Hiddenbed is designed as a beam structure affording the same flexibility and support of a standard mattress foundation (box spring).

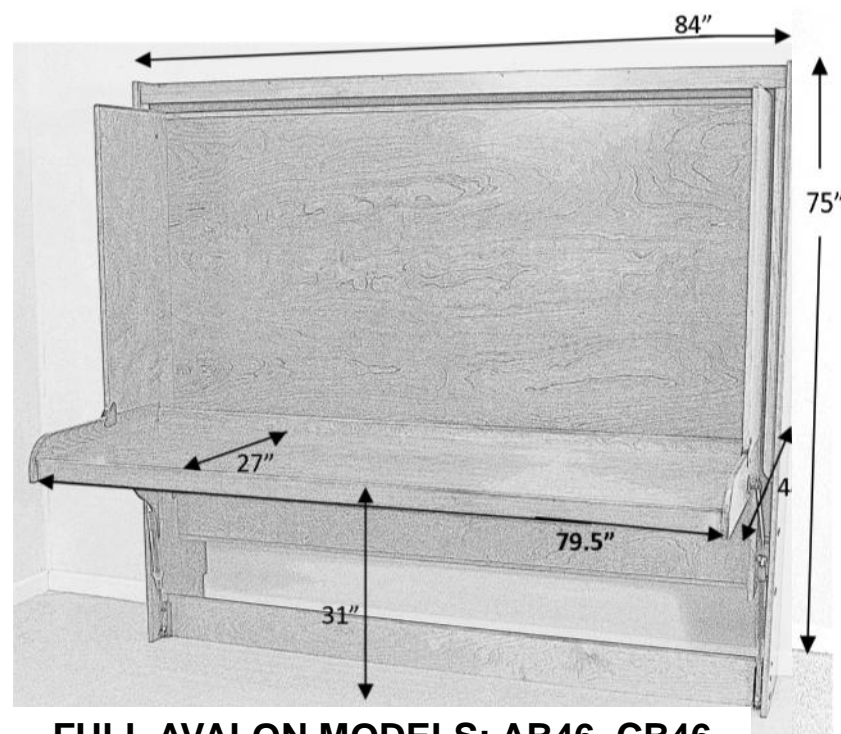
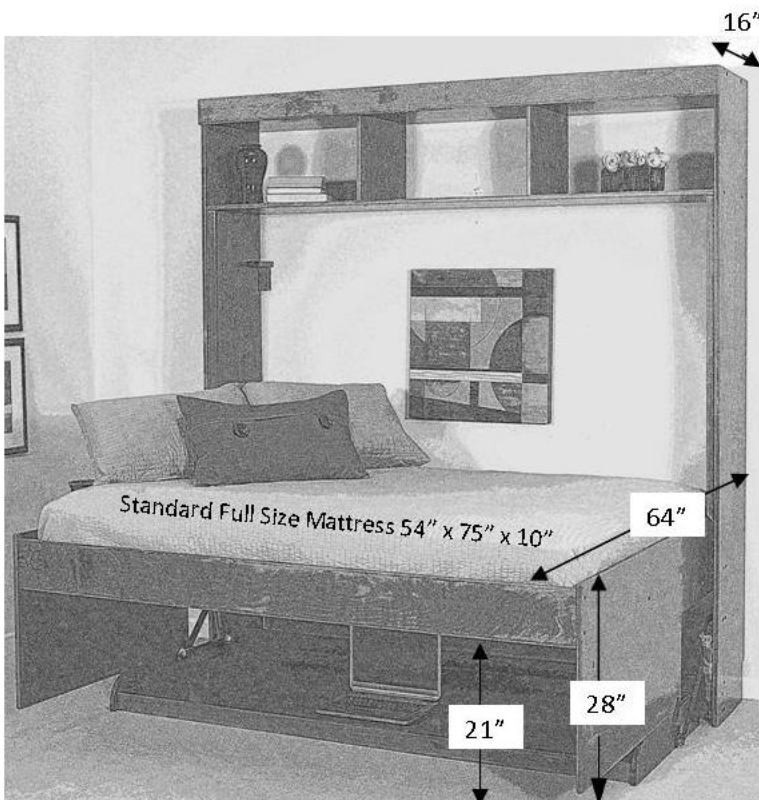

FULL AVALON MODELS: AB46, CB46

Please refer to actual wood samples for true representation of the finish



CHOCOLATE BIRCH



CHERRY BIRCH



CINNAMON BIRCH



MAPLE BIRCH



NATURAL BIRCH



WHITE BIRCH



SUNSET BIRCH

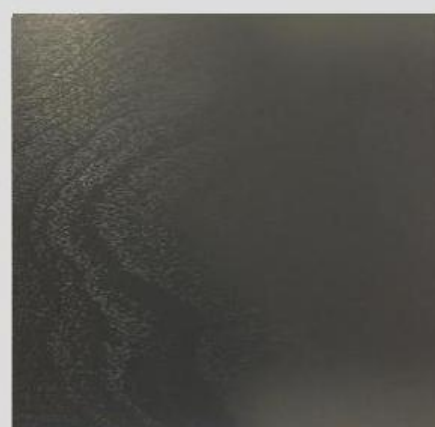

GRAY BIRCH

White finish is NOT a paper or plastic overlay on particleboard, but a full furniture lacquer finish on wood and is designed to reveal the joinery and grain character of the furniture. The process includes hand detailing of all surfaces and joints, a high solid undercoat, touch sanding and final pigmented lacquer top coat. The overall appearance will provide an even coloring, but subtly reveal the joinery seams and wood grain effects of your true wood furniture.

Hiddenbed ™



SUNSET OAK



LIGHT OAK



NATURAL OAK





WHAT MAKES OUR HIDDENBED'S BETTER?

ALL HARDWARE IS PRE-MOUNTED

You will receive your Hiddenbed with all the hardware assembly plates attached making our Hiddenbed the easiest to assemble in the industry. **No sub-assembly required!**

LEADER IN HIDDENBED MANUFACTURING

For over 15 years **we have crafted the Hiddenbed in California, U.S.A.** We meet all stringent California Manufacturing requirements; the toughest in the country (California C.A.R.B. Compliant.)

IMPROVED DESIGN

We **REINFORCED** the underside of the desktop so it can withstand twice the weight specified. We have modified from the original design to include features that allow the bed to **Install more easily and function properly** as these beds employ a folding parallelogram design, the mechanism holes can not be off by even 1mm.

THOUSANDS OF OUR HIDDENBEDS ARE IN USE

which are operated successfully every day!

REAL WOOD FINISHED

Unlike other Hiddenbeds, our beds are made from solid hardwood and hardwood veneer on premium furniture grade plywood. Nine step hand rubbed finish gives our beds a smooth surface with even color tones.

You can find our products successfully used in commercial properties such as time-shares, hotels, dormitories etc...

THE BEST DESIGNS WITH MATCHING FURNITURE OPTIONS

With over 20 different side pier configurations, you will find exactly what you need to make the most of your space; from filing cabinets, wardrobes and filing carts to name a few.

HIDDENBEDS and MURPHY WALLBEDS ARE ALL WE DO!

Our focus is to continue to make quality space saving furniture that you will be proud to own.



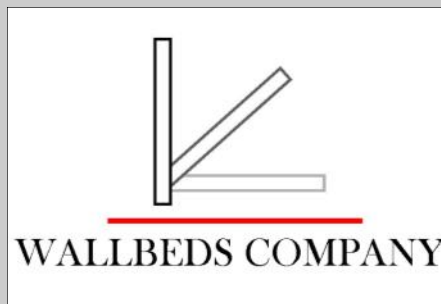

All Products are Proudly Made in the U.S.A.

PRODUCT OF WESTCOTT DESIGNS INC.
4455 PARK ROAD
BENICIA, CA 94510
800-934-6711
Email: wallbedscompany@gmail.com
Website: www.wallbedscompany.com